



AV500 Powerline Adapter Quick Installation Guide

Model No. PL7500/PL7500 Kit

1. Packet Content



2. Warning Before Installation

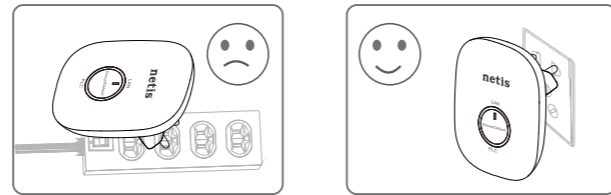

Tip: It's strongly recommended that you plug the adapter directly into the wall socket, for some power strips have surge protector which can filter the data.

3. LED and Button Descriptions

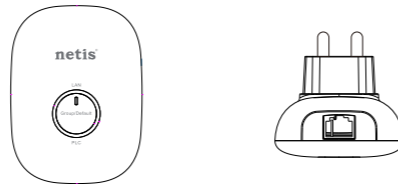

Tip: Different power plug is provided for different region. Here we take the EU version for example.

LED	Status	Indication
PLC	On	The adapter is connected to the powerline network and transferring powerline data.
	Quick Flashing	The adapter is waiting for pairing/ is pairing.
	Slow Flashing	The Ethernet cable is not connected and adapter is in power-saving mode/the adapter is not connected to a powerline network.
LAN	Off	No power
	On	The Ethernet cable is connected/ transferring data.
Button	Description	
	Group	Group button is used to secure a powerline network. To secure your network, please refer to Appendix: Using the Group Button.
Default	Default button is used to set factory defaults.	

5 minutes after the LAN port is disconnected or the connected device is turned off, the powerline adapter will automatically switch to power-saving mode.

4. Network Installation

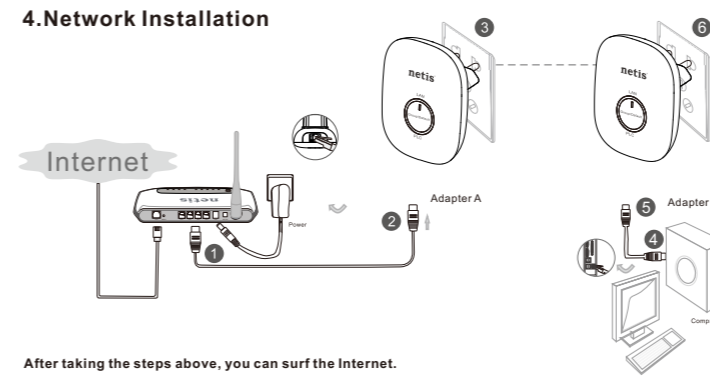

After taking the steps above, you can surf the Internet.

NOTE:
1). As soon as the powerline adapters are connected as above, a usable powerline network is built up. To secure the network, please refer to the Appendix: Using the Group Button
2). Please make sure that your network is properly connected to the Internet.

Appendix: Using the Group Button (Setting up a private group)

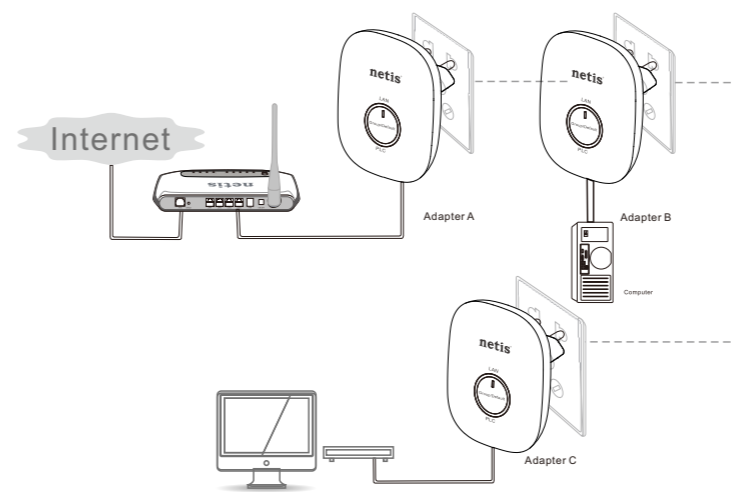

To set up a private group:

- 1). Press the Group button on Adapter A for 1 second and the Powerline LED will begin flashing.
- 2). Within 2 minutes, press the Group button on Adapter B for 1-3 seconds and the PLC LED will begin flashing as well. In about 60 seconds you'll see the PLC LED on both adapters light up, indicating that the two adapters have intercommunicated with each other successfully.

Tip 1: It is highly recommended to first set up the two adapters as close as possible and then place them in a suitable location.

To join an existing private group:

- If you want to add adapter C to the existing private group, please follow the steps.
- 1). Press the Group button on the Adapter A or B for 1 second (do not press both), and the Powerline LED will begin flashing.
 - 2). Within 2 minutes press the Group button on Adapter C for 1 second, the Powerline LED on the adapter C will light up in about 60 seconds.

Tip 2: You can follow the steps above to add more adapters to the private group one by one.

Tip 3: If you want to reset or rename the device please install the Powerline Utility from the resource CD. (Only for Windows)

Troubleshooting

Q1. I have followed the above instructions, but my adapters are still not working. What can I do?

- 1). Make sure that all the adapters are under the same electric meter.
- 2). If the Power LED does not light up at all, there may be a hardware problem.
- 3). The powerline devices might not communicate with each other if they are in different phases of a four-wire three-phase circuit
- 4). As some power strips have surge protector, please make sure the adapters are not separated by the them.

Q2. The adapters were working fine but no longer work now since they've been moved. How do I make them work again?

Plug the adapters into the same power strip and follow Appendix Using the Group Button to group them. If they still don't work, please check for possible interference causes:

- 1). Air-conditioners, washing machines, and other similar household appliances are working too close to the adapters.
- 2). Air switch may lead to failed communication among powerline devices. check whether there are air switches hindering communication.

Q3. How can I restore the factory defaults?

With the adapter is powered on. Press the default button at least 15 seconds.

NETIS SYSTEMS CO., LTD.
www.netis-systems.com
MADE IN CHINA

PKUM05627



AV500 Powerline Adapter Quick Installation Guide

Español

Después de realizar los pasos anteriores, pueden navegar por Internet.

NOTA:
1. Tan pronto como los adaptadores para cable eléctrico estén conectados como se indica anteriormente, dispondrá de una red a través de cables eléctricos lista para usarse.
2. Asegúrese de que la red está correctamente conectada a Internet.

Português

Depois de executar os passos indicados acima, poderá navegar na Internet.

NOTA:
1. Após a ligação dos adaptadores powerline, tal como indicado acima, a rede powerline será criada.
2. Assegure-se de que a sua rede está devidamente ligada à Internet.

Français

Une fois l'installation faite comme ci-dessus, vous êtes prêt pour surfer sur Internet.

Note
1. Dès la connexion de l'adaptateur CPL [Adaptateur Courant Porteur en Ligne], une ligne réseau est disponible.
2. Vérifiez que votre réseau est bien connecté à Internet.

Italiano

Una volta effettuata le procedure precedenti, è possibile navigare su Internet.

NOTA:
1. Quando gli adattatori Powerline sono collegati come indicato in precedenza, viene creata una rete Powerline utilizzabile.
2. Assicurarsi che la rete sia collegata correttamente a Internet.

Deutsch

Nach Durchführung der obigen Schritte können Sie im Internet surfen.

HINWEIS:
1. Sobald die Powerline-Adapter wie oben angeschlossen sind, ist ein nutzbares Powerline-Netzwerk hergestellt.
2. Bitte stellen Sie sicher, dass Ihr Netzwerk richtig mit dem Internet verbunden ist.

Nederlands

Na de bovenstaande stappen te hebben gezet, kunt u over internet surfen.

OPMERKING:
1. Zodra de lichtnet-adapters zijn aangesloten zoals hierboven is beschreven, is een bruikbaar netwerk via het lichtnet ontstaan.
2. Controleer of het netwerk met internet is verbonden.

Polski

Po wykonaniu powyższych czynności możesz surfować po Internecie.

UWAGA:
1. Jak tylko zasilacze sieciowe zostaną podłączone w powyższy sposób, stworzona zostaje użyteczna sieć w przewodach energetycznych.
2. Upewnij się, że sieć jest odpowiednio połączona z Internetem.

Čeština

Po provedení výše uvedených kroků můžete začít používat Internet.

POZNÁMKA:
1. Po zapojení adaptérů pro elektrické rozvody výše uvedeným způsobem bude vytvořena v elektrickém rozvodu funkční síť.
2. Zkontrolujte, zda je vaše síť řádně připojena k Internetu.

русский

После выполнения вышеуказанных мер, Вы можете использовать Интернет.

ПРИМЕЧАНИЕ:
1. Как только Powerline адаптеры подключены, как описано выше, сеть Powerline готова к использованию.
2. Пожалуйста, убедитесь, что ваша сеть правильно подключена к Интернету.

Türkçe

Yukarıdaki adımları tamamladıktan sonra, Internet'te gezinebilirsiniz.

NOT:
1. Güç adaptörleri yukarıdaki gibi bağlanırlı bağlanmaz, kullanılabilir bir güç ağı oluşur.
2. Lütfen ağınızın Internet'e düzgün bağlandığından emin olun.

繁體中文

採取上述步驟後，便可以瀏覽互聯網。

注意：
1. 一旦電力線橋接器以上述方式連接後，便會建立可用的電力線網路。
2. 請確認您的網路已妥善連接到互聯網。

NETIS SYSTEMS CO., LTD.
www.netis-systems.com
MADE IN CHINA